

Remove → improve

THE CHURCH

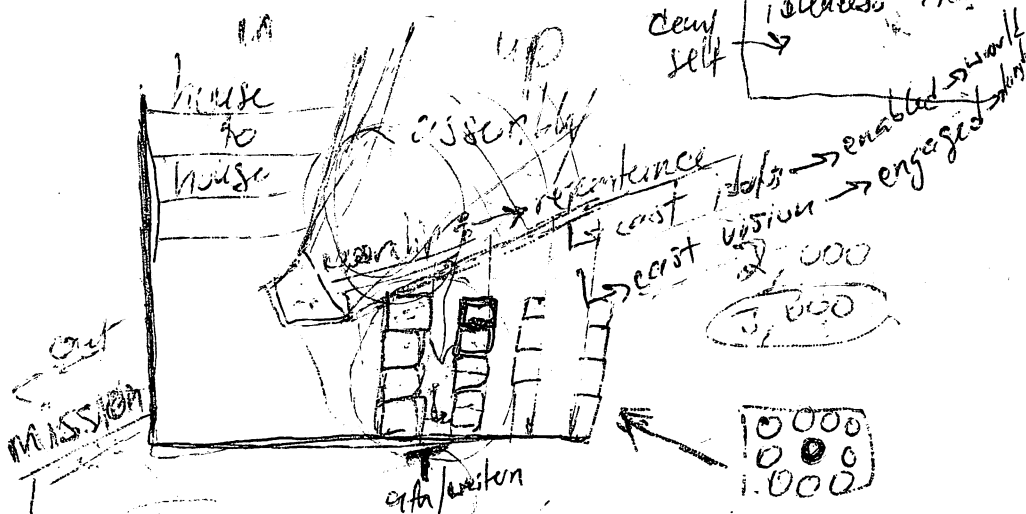

self → program statement
 idols → idleness
 idleness → idols
 cast self → enabled sinners
 engaged

missional communities → house churches
 resisting the devil → flex
 unity ↔ diversity
 denominations → unity = the church

disciple = the role of the church

a water

- up: celebration 1/3
- (in) character: 1/3
- out: commission 2/3

equip
 release

decreasing → increasing

- * acts 1:8 → sabbath night
- * casting down idols

not to be provided
 decrease → increasing
 self-sacrifice

* fatherless
 ↳ nehemiah

* Isaiah
 restoring stress
 physical